

Plan-scheme

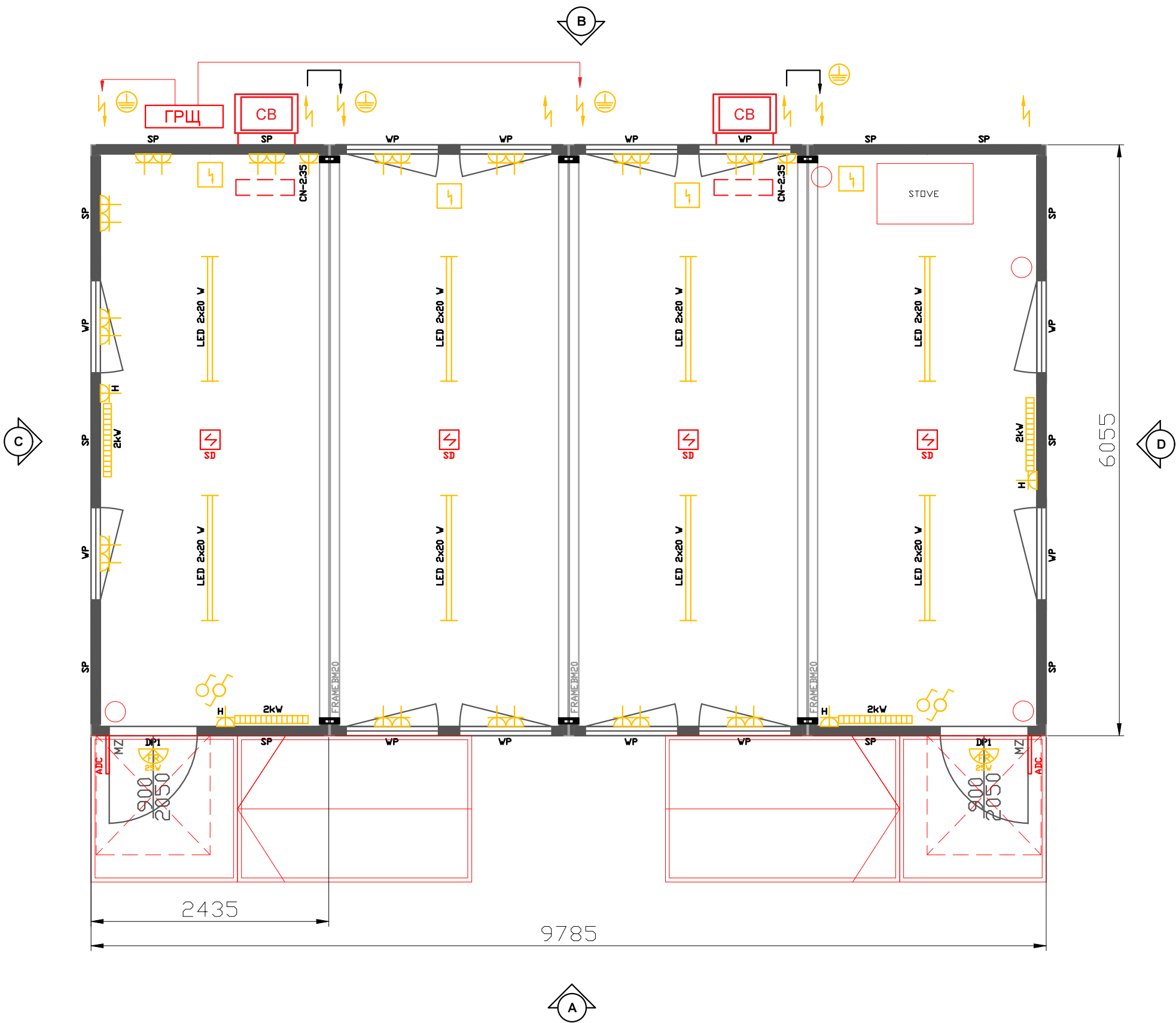

**Module complete set:**  
4 pc. 20' (2,435 x 6,055 x 2,800 m)

- Size, insulation:**
- painted metal frame made of special section profiles
  - internal module height 2440 mm
  - external walls made of sandwich panels
  - reinforced floor structure, cbpb (cement bonded particle board) in floor construction 19 mm
  - thermal insulation mineral wool 150/100/100 mm (floor/wall/ceiling)
  - glazing double-glazed window, PVC profile WDS, 900 x 1200 mm, white with build-in roller shutters
  - without holes for loader forks
  - insured steel entrance door Hormann type MZ 900 x 2050 mm T30

- Decoration and finishing:**
- outside module frame color RAL 7004
  - module roof color RAL 7004
  - outside module walls color RAL 9006
  - exterior door color RAL 7004
  - windows color white
  - ceiling white, LPB
  - the color of the walls inside is light oak, LPB
  - floor finish - semi-commercial linoleum
  - finishing around the stove - metal corrugated sheet 3 mm. on the floor, on the wall and ceiling stainless steel lined with fire-resistant insulating material

- Electrician:**
- 5-pin external socket and plug recessed into the frame type CEE 400 V, 32 A
  - electrical wiring hidden in PVC pipes
  - inside an electrical distribution board with an RCD differential switch
  - electrical panel on the ceiling
  - circuit breakers NOARK Electric
  - cable production
  - sockets, switches, junction boxes
  - LED lightning 2 x 20 W
  - terminal for connecting the module frame to the ground loop
  - electric heaters 2 kW

- Additional equipment:**
- wireless smoke detector
  - door closer
  - conditioners
  - fire extinguishers
  - canopies and platforms for entrances

- Legend:**
- Automatic door closer
  - LED lamp 2x20 W
  - Heater 2 kW
  - One-button switch
  - One-key pass-through switch
  - External socket and plug type CEE 400 V, 32 A, 5-pole
  - Output to ground loop
  - Electrical distribution board
  - Power socket
  - Heater power socket
  - Wireless smoke detector
  - Fire extinguisher